



Linear Parking Garage Light



PROJECT INFORMATION

JOB NAME	
FIXTURE TYPE	Linear Parking Garage Light
CATALOG NUMBER	
APPROVED BY	

SPECIFICATIONS

Construction:

The 1-piece housing is made of durable composite material with 1/2" entry points on both ends. The poured gasket provides a continuous seal for the lens. Eight polycarbonate cam latches compress lens to housing for a tight seal. Stainless steel mounting brackets are furnished with each fixture.

Lens:

Injection molded acrylic lens with high impact additive. Lens is frosted to eliminate glare.

Electrical:

AC Input: 120/208/240/277V 347/480V

Constant current, Class 2 120-277 VAC, 47-63Hz

High Efficiency – min. 85%

Off-State Power: 0 Watts

Temperatures: Min Start: -40°C Max: 40°C

LEDs:

Atlas LEDs provide higher lumen output, greater energy efficiency and more reliable fixture performance. LEDs manufactured for the ILW series utilize Epoxy Guard conformal coating which reduces the chance of board corrosion.

200,000+ hrs.¹ lifespan

ILW series fixtures operate at 3000K, 4000K, 4500K and 5000K CCT.

Listings:

Luminaire is certified to UL/cUL Standards for Wet Locations DesignLights Consortium Premium qualified luminaire, eligible for rebates from DLC member utilities. *See chart on next page for qualifying products.*

Ratings:

NEMA4X

IP65, IP66 & IP67

NSF

1500 PSI Hose Down

Testing:

Atlas LED luminaires have been tested by an independent laboratory in accordance with IESNA LM-79 & LM-80.

Applications:

Cold storage, garages, refrigerated cases, stairwells, storage areas, fuel pump canopy, low-bay fixtures for commercial & industrial buildings.

Installation:

Fixture retains the same knock-out sizes and positions as previous models, reducing wiring costs. Mounting bracket allows unit to be hung with aircraft cable.

Warranty:

Five-year limited warranty

NEMA 4X

NSF

IP65 RATED

IP66 RATED

IP67 RATED

MANUFACTURED & TESTED IN USA

DLC QPL PREMIUM

UL US LISTED

WET LOCATIONS

BUY AMERICAN COMPLIANT*

DIMENSIONS

Weight: 9.5 lbs.

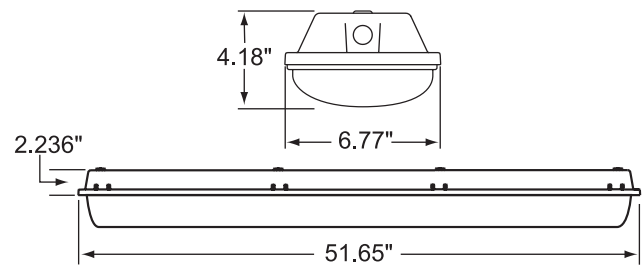

¹LED Life Span Based Upon LM-80 Test Results

Rebates and Incentives are available in many areas. Contact an Atlas Representative for more information.

*The majority of Atlas Lighting Products are assembled in USA facilities by an American Workforce utilizing both Domestic and Foreign components. Meets Buy American requirements within the ARRA.



Linear
Parking Garage Light



ORDERING INFORMATION

ILW	48LED	4	D		PG
PRODUCT SERIES	WATTAGE	FIXTURE LENGTH	BODY STYLE	COLOR TEMP.	OPTIONS
ILW = LED Linear Wet Location	48LED - 48 System Watts	4 = 4 Feet	D = Narrow Body	Blank = 4500K 3K = 3000K 4K = 4000K 5K = 5000K	xC* = 3' Cord (No Plug) EB = Emergency Back-Up L = SS Latches 4 = 480V Driver ALSC - Airlink Synapse Wireless Control System ALSCS - Airlink Synapse Wireless Control System with Sensor IMSOM2 - Integral Motion / Daylight Sensor. Mounting Height >20' IMSOM4 - Integral Motion / Daylight Sensor. Mounting Height >45' OCSWL - Wet Location Occupancy Sensor PG = Parking Garage <small>*x = 3 for 3' Cord; 6 for 6' cord, 10 for 10' cord; and 20 for 20' cord lengths</small>

PERFORMANCE DATA

UNIT	FIXTURE LENGTH	CRI	3000K CCT		4000K CCT		4500K CCT		5000K CCT		WATTAGE	REPLACES UP TO
			DELIVERED LUMENS	EFFICACY (LPW)	DELIVERED LUMENS	EFFICACY (LPW)	DELIVERED LUMENS	EFFICACY (LPW)	DELIVERED LUMENS	EFFICACY (LPW)		
ILW48LED	4'	80	6,409	134	6,459	139	6,409	134	6,453	135	48	4L T8 FL

DLC PRODUCT INFORMATION

UNIT	FIXTURE LENGTH	3000K CCT		4000K CCT		4500K CCT		5000K CCT	
		DLC PRODUCT ID	CLASSIFICATION	DLC PRODUCT ID	CLASSIFICATION	DLC PRODUCT ID	CLASSIFICATION	DLC PRODUCT ID	CLASSIFICATION
ILW48LED	4'	n/a	n/a	PCONS6PH	Premium	PGKT0PDQ	Premium	PWOOERGV	Premium

IP RATING

	DESCRIPTION	DEFINITION		DESCRIPTION	DEFINITION
6	Dust-tight	No ingress of dust	6	Dust-tight	No ingress of dust
5	Protects against water jets	Water projected from a nozzle against the enclosure from any direction shall have no harmful effect	7	Protects against the effects of immersion	Ingress of water in a harmful quantity shall not be possible when the enclosure is immersed in water under defined conditions of pressure & time
6	Dust-tight	No ingress of dust			
6	Protects against powerful water jets	Water projected in powerful jets against the enclosure from any direction shall have no harmful effect			