

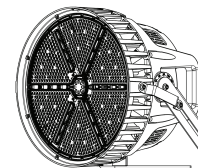

Model: SPTS
Patriot Series Sports Light
 Installation and Assembly Instructions



⚠ WARNING

Risk of fire, electric shock, injury, or property damage

Risk of electric shock--Disconnect power to equipment before installing or servicing.
 This equipment must be installed according to all applicable codes & ordinances.
 Installation and service of this equipment must be performed by qualified service personnel.
 Do not install damaged equipment.
 Read these instructions before installing, servicing, or maintaining this equipment.
 Save these instructions for maintaining and servicing.

⚠ CAUTION

Failure to follow instructions or altering equipment could result in damage and void warranty.
 Edges may cut--wear gloves while handling or servicing this equipment.
 Inspect equipment for damage from shipping and handling.

LUMINAIRE PREPARATION

1. Remove the luminaire from the carton and inspect luminaire for damage. Do not install a damaged luminaire.
2. Identify which model has been ordered and determine mounting method for appropriate mounting instructions on the following pages.

WIRING INFORMATION

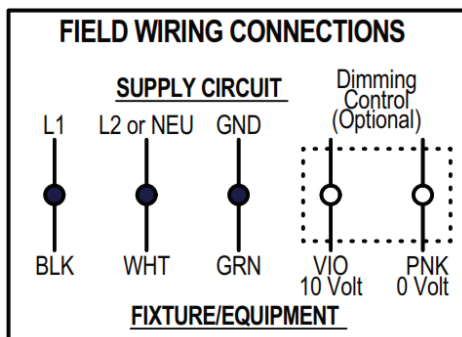

Integral Bluetooth Motion and Photocell Sensor Option – IMSBTL

The sensor configuration app is available for both iOS and Android devices. Search the APP Store for LSI sensor configuration and download. It is used to set up a password, change default settings and testing. If no password is set within 7 days of the sensor being powered up it will need to be reset. For complete details download the LSI Sensor Config App User Guide <https://www.lsicorp.com>



Model: **SPTS**
Patriot Series Sports Light
Installation and Assembly Instructions

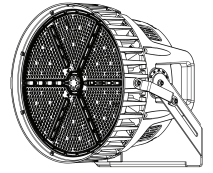

HANDLING INSTRUCTIONS

Remove the luminaire from the carton. Inspect the luminaire and mounting locations for any damages. If the fixture is damaged, do not use. Ensure the mounting location is suitable for the luminaire and rated to support the weight of the fixture.

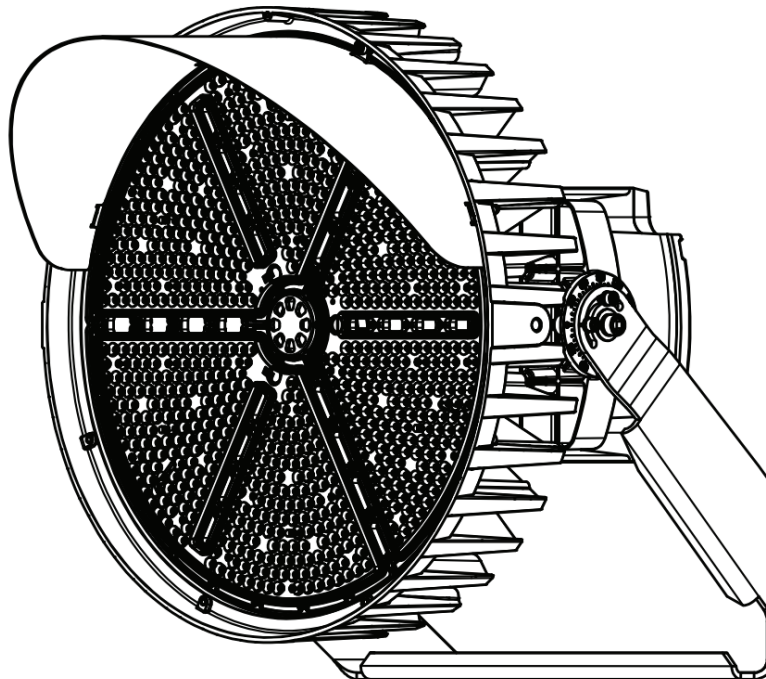
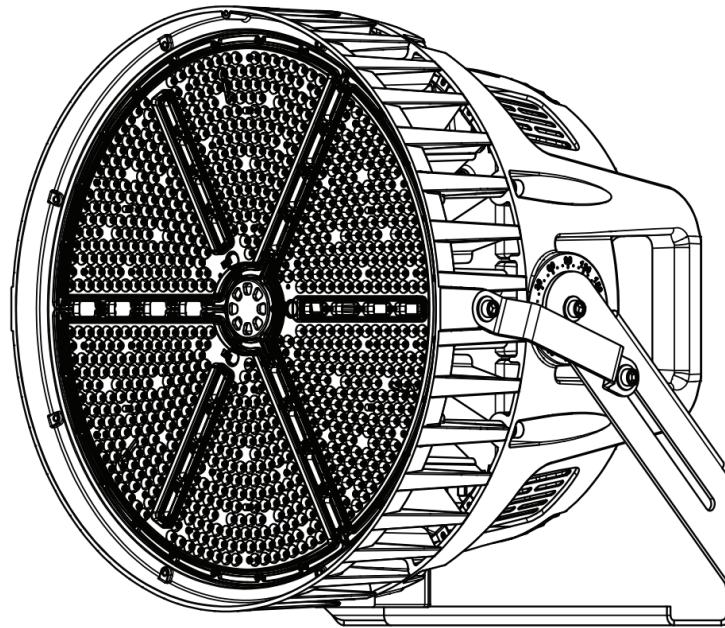



Model: **SPTS**
Patriot Series Sports Light
Installation and Assembly Instructions

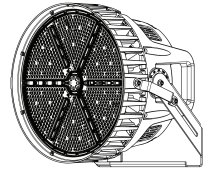

MOUNTING

Make sure supply power is **OFF** prior to installation. Installing with live supply voltage can damage electronics and void fixture warranty.

Note: Packaging materials should be used to protect paint finish when assembling fixture and mounting bracket on parking lot surface or ground.

Visor

Tools Required: 5mm Hex Key Wrench, 8mm Hex Key Wrench, 17mm Hex Key Wrench

1. Insert (4) m5 screws through visor into the fixture and tighten to 7 ft/lbs.
2. Insert (1) m12 bolt and nut and tighten to 50 ft/lbs.
3. Insert (2) m10 bolts and nuts and tighten to 40 ft/lbs.

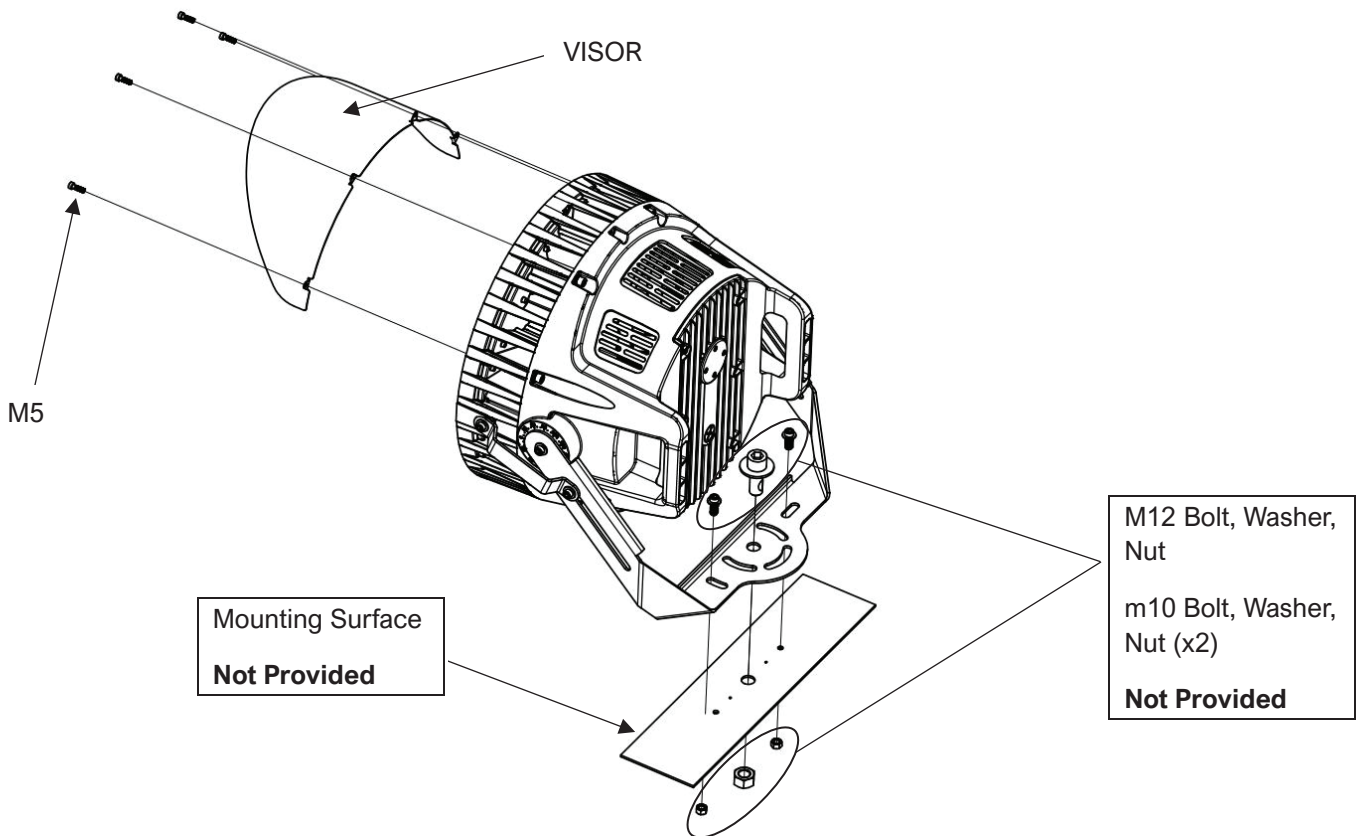



Model: **SPTS**
Patriot Series Sports Light
Installation and Assembly Instructions

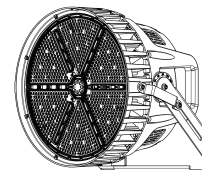

Slip Fitter

Tools Required: 13mm Socket Wrench, Philips Head Screw Driver

1. Adjust luminaire to desired angle.
2. Align slip fitter as shown below, insert (1) m10 screw, using 8mm hex key wrench torque to 40 ft/lbs.
3. Align access cover and insert (2) screws using Philips head screwdriver to 1ft/lbs.

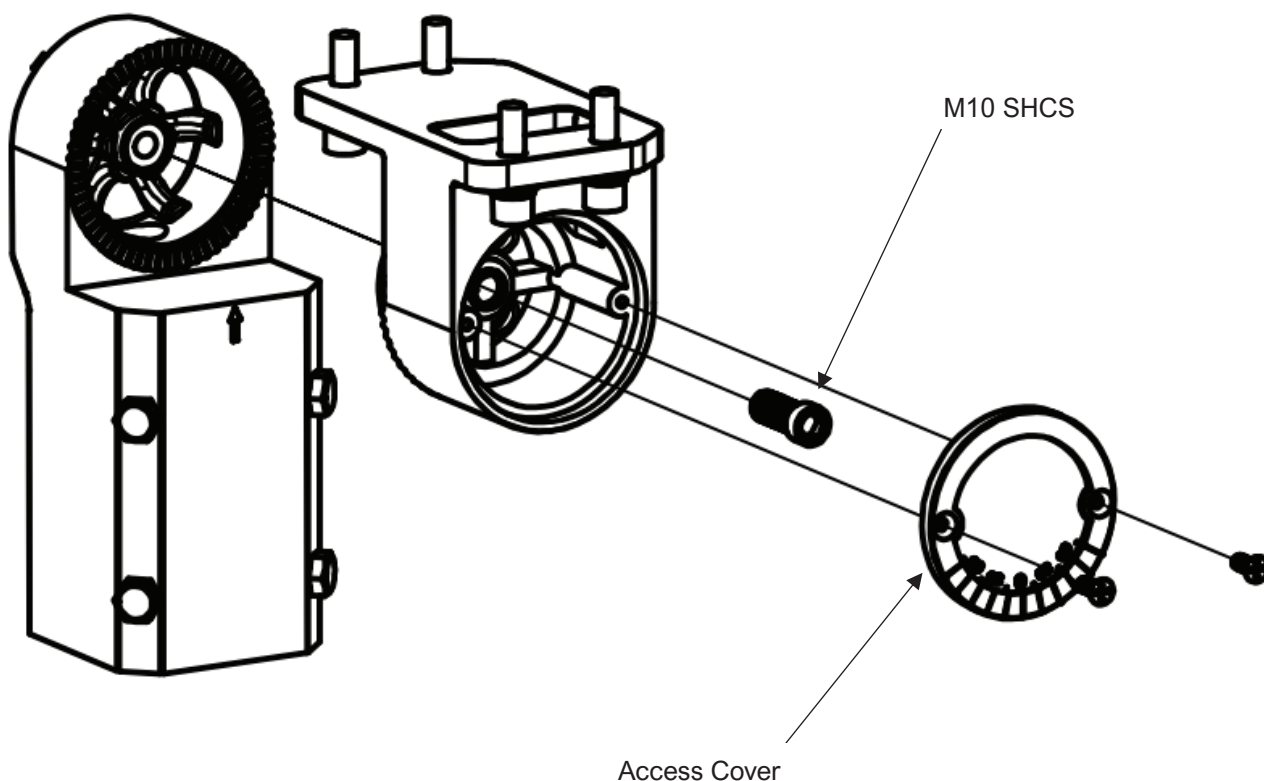



Model: **SPTS**
Patriot Series Sports Light
Installation and Assembly Instructions

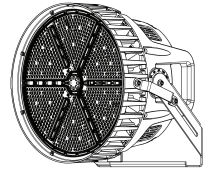

Slip Fitter

Tools Required: 13mm Socket Wrench, 6mm Hex Key Wrench

4. Align slip fitter as shown below, screw (4) m8 screws, using 6mm hex key wrench into the bottom of the fixture and tighten to 25 ft/lbs.
5. Slide fixture with slip fitter over pole and tighten (4) m8 screws with 13mm socket wrench to 25 ft/lbs.

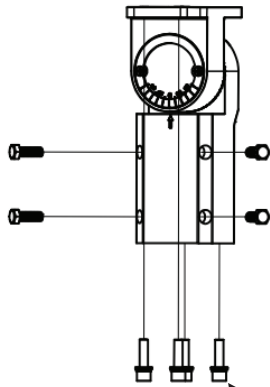
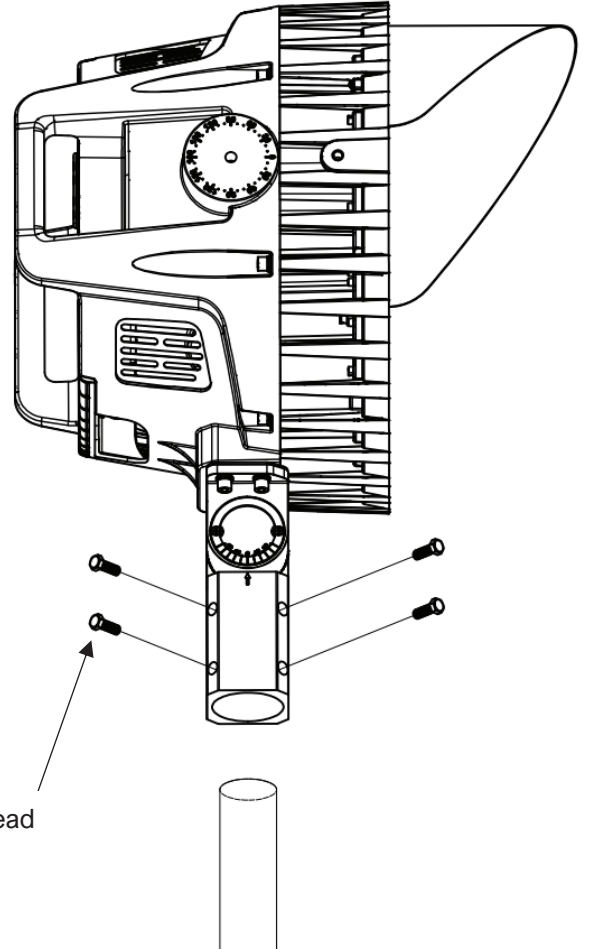
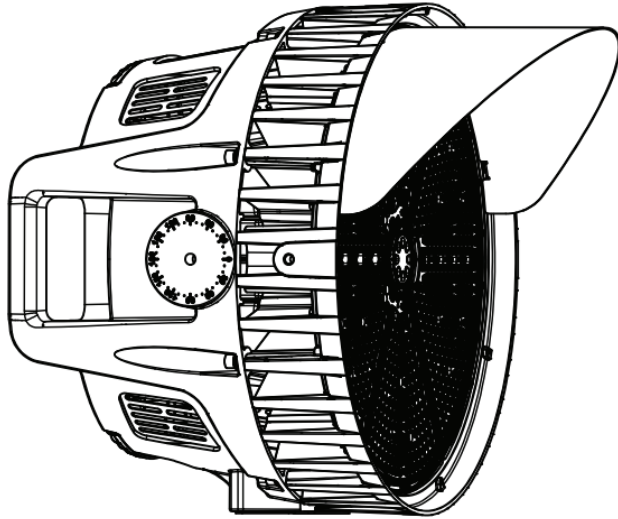

M8 SHCS

M8 Hex Head



Model: **SPTS**
Patriot Series Sports Light
Installation and Assembly Instructions

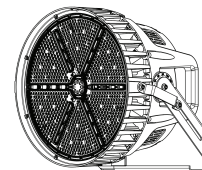

Remote Driver

Tools Required: 8mm Hex Key Wrench

1. Connect cable from heat sink into remote driver.
2. (Or connect extension cable to heat sink cable, and then connect that to remote driver)
3. Align (4) holes on remote driver and insert (4) m8 screws with washers, using 6mm hex key wrench and tighten to 25 ft/lbs.

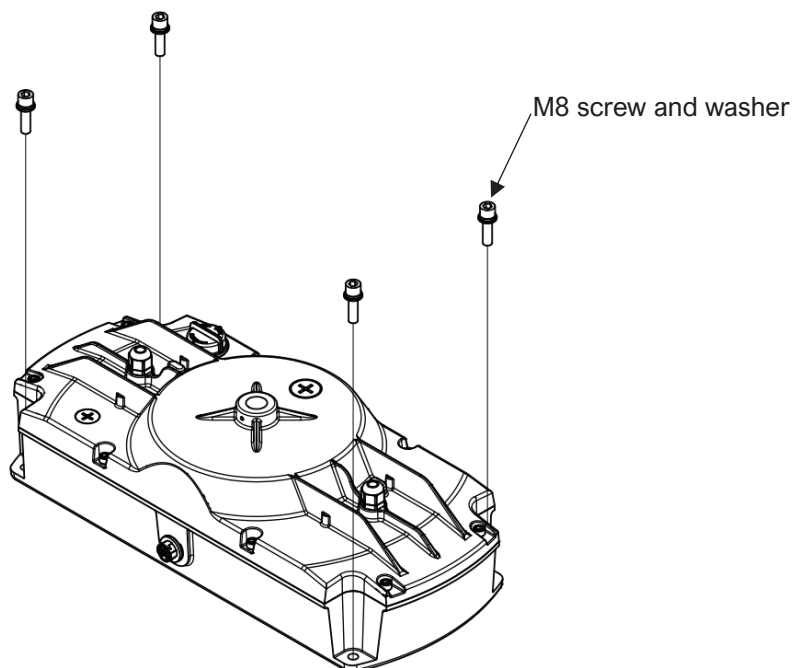
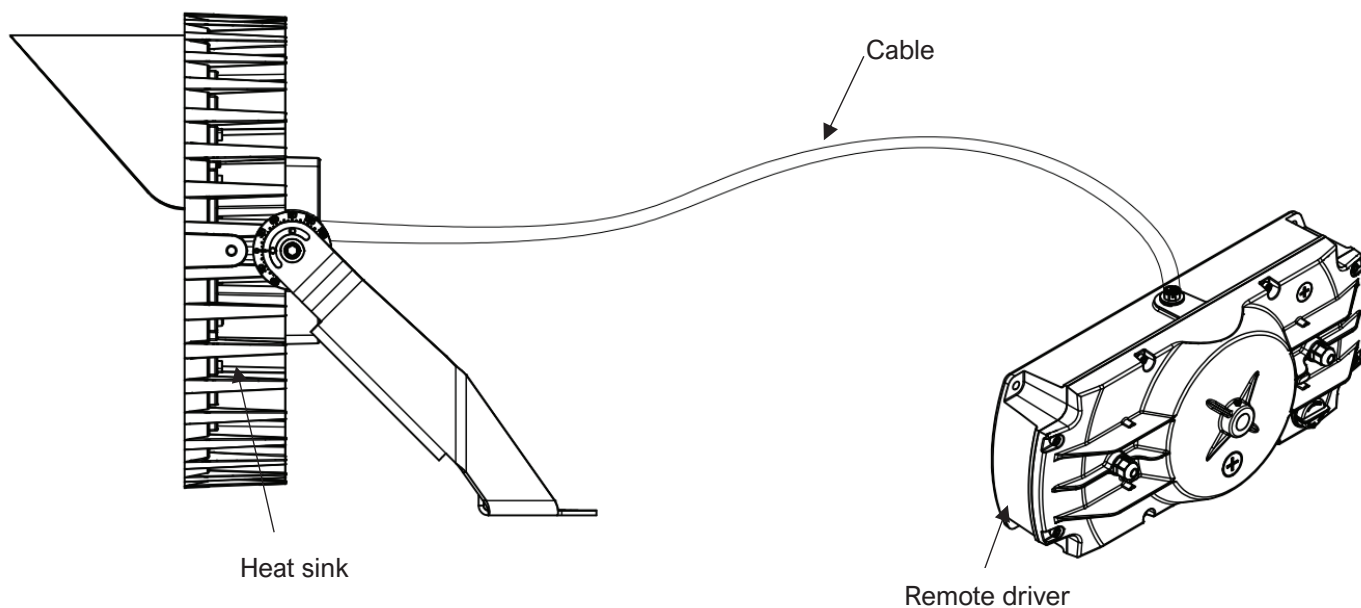



Model: **SPTS**
Patriot Series Sports Light
Installation and Assembly Instructions

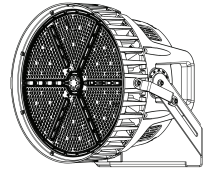

Angle (X Axis)

Tools Required: 10mm Hex Key Wrench

1. Slightly loosen screw shown below in order to adjust angle.
2. Once desired angle is achieved tighten with hex key wrench to 50 ft/lbs.

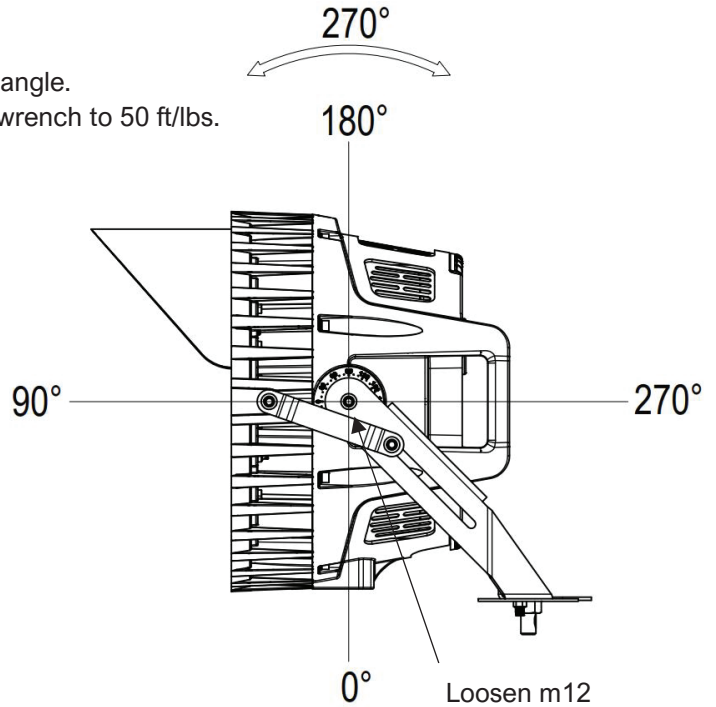

Angle (Y Axis)

Tools Required: 5mm Hex Key Wrench, 8mm Hex Key Wrench, 17mm Hex Key Wrench

1. Slightly loosen mounting screws in order to adjust angle.
2. Once desired angle is achieved tighten with hex key wrench.

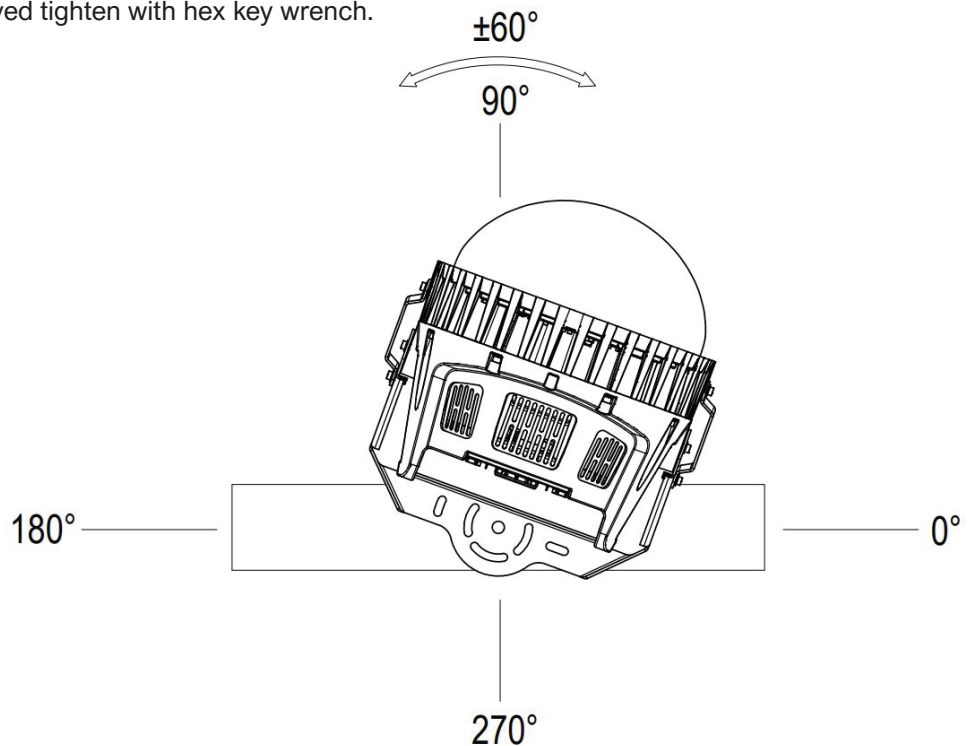



Model: **SPTS**
Patriot Series Sports Light
Installation and Assembly Instructions

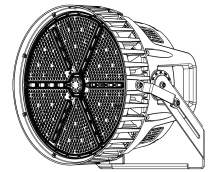

Angle (Y Axis)

Tools Required: Phillips screwdriver.

1. Align laser bracket with mounting hole on top of fixture. Use Philips head driver tighten to 2 ft/lbs.

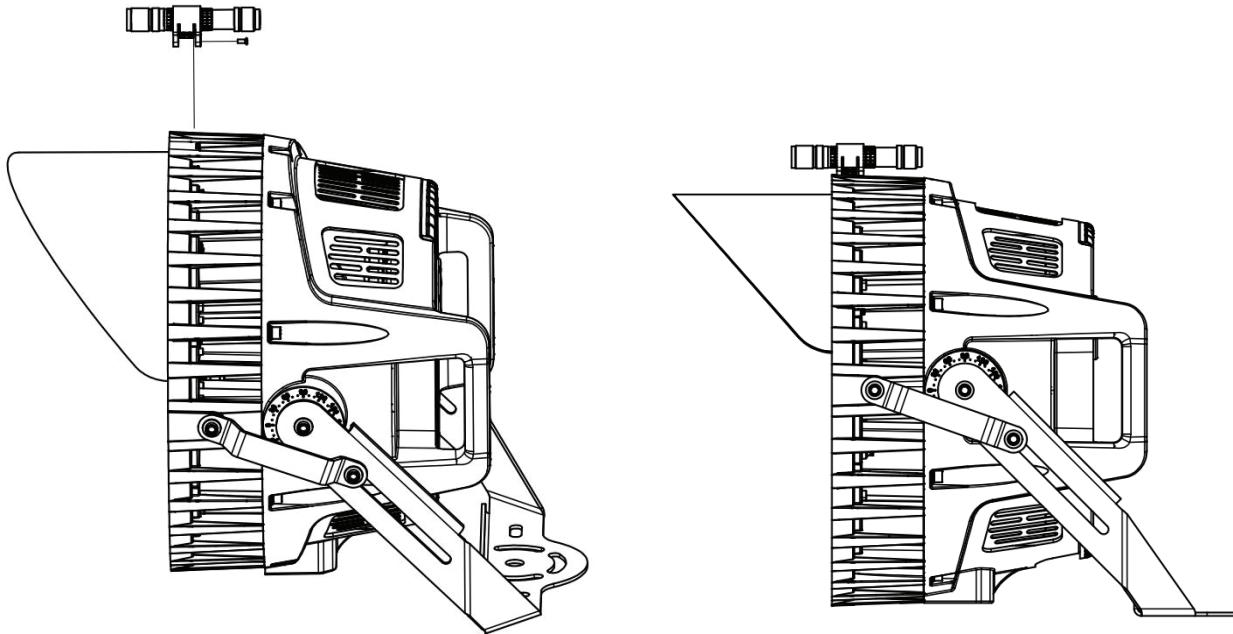

WARNING

NEVER point the aiming laser at any person or animal as it can cause permanent damage to eyes. Use laser only for aiming fixtures as directed. FAILURE TO FOLLOW THIS WARNING MAY LEAD TO SEVERE INJURY.

ATLAS LIGHTING PRODUCTS, INC.'S LIMITED WARRANTY

THREE OR FIVE-YEAR LIMITED WARRANTY: Atlas warrants that its products will be free from failure in materials and workmanship for a period of three (3) years from the date on which the product was purchased from Atlas. This warranty applies to LED products for a period of five (5) years. When this three or five-year warranty period ends, all warranties (whether express or implied) and liability of Atlas shall immediately cease. The warranty period for all lamps and photocells is one (1) year.

LIMITATION ON IMPLIED WARRANTIES: ALL IMPLIED WARRANTIES, INCLUDING IMPLIED WARRANTIES OF MERCHANTABILITY AND FITNESS FOR ANY PARTICULAR PURPOSE, ARE LIMITED TO AND SHALL NOT EXCEED THE TERMS OF THIS LIMITED WARRANTY.

FURTHER LIMITATIONS OF THIS WARRANTY: This limited warranty **DOES NOT** cover damage resulting from accident, misuse, abuse, improper repair, lack of reasonable care, modification (including but not limited to use of unauthorized parts or attachments), alteration, loss of parts, installation and operation contrary to printed instructions, vandalism, acts of God (lightning, power surges, water damage or similar failure), or transit (including UPS shipments). This limited warranty also does not include labor costs associated with installing replacement parts for any failed parts returned to Atlas under this warranty.

DUTY AND PROCEDURE TO NOTIFY ATLAS OF FAILED PRODUCT: Notification of a failed product under this warranty must be provided to Atlas within ninety (90) days after discovery of the failure. Notification occurs only by sending the following to Atlas: (1) sales receipt, (2) the date of purchase, and (3) a brief explanation of the nature of the failure. This information must be either e-mailed to Atlas at returns@alpinc.com or mailed to Atlas Lighting Products, Inc., Attn: Returns Department, P.O. Box 2348, Burlington, NC 27215. The date of the postmark of the mailing to Atlas shall constitute the date of notification under this warranty. If the information is e-mailed, the date that the e-mail is sent to Atlas shall constitute the date of notification under this warranty. Upon receiving a timely notification, Atlas will, if the notification reflects a failure of materials or workmanship, provide a Return Goods Authorization number and full instructions for returning failed merchandise. **All returned goods must be accompanied by a Return Goods Authorization number issued by Atlas.**

SOLE REMEDY: REPAIR OR REPLACEMENT: If, upon receiving a timely notification with the information stated above and receiving merchandise that appears to Atlas to have a failure in materials or workmanship, Atlas will — at Atlas's sole option — either repair the failed part(s) or provide a replacement part or parts. This remedy constitutes the sole remedy under this warranty and Atlas's sole liability in connection with any failed part(s). **Atlas shall not be liable for any other expense, injury, loss or damage, whether direct, special, incidental, or consequential (including but not limited to loss of use, income, profit, or production, inconvenience, increased cost of operation, and spoilage of or damage to material and personal property).** As stated above, this limited warranty does not include labor costs associated with installing replacement parts for any failed parts returned to Atlas under this warranty.

NO OTHER REPRESENTATIONS: No other representations, written or verbal, have been authorized by Atlas. No representative of Atlas has any authority to waive, alter, vary, or add to the terms hereof without prior approval in writing by an authorized representative of Atlas.

SEVERABILITY: The foregoing provisions are severable. If any provision shall be unenforceable for any reason, the other provisions shall remain in effect.

DISCLAIMER: ATLAS LIGHTING PRODUCTS, INC. MAKES NO REPRESENTATIONS (WRITTEN OR VERBAL) OR WARRANTIES (EXPRESS OR IMPLIED) AS TO ANY MATTER WHATSOEVER, INCLUDING WITHOUT LIMITATION THE CONDITION, MERCHANTABILITY, OR FITNESS FOR ANY PARTICULARLY PURPOSE OF ANY PRODUCT, EXCEPT AS EXPRESSLY SET FORTH UNDER THIS LIMITED WARRANTY.

THIS WARRANTY GIVES YOU SPECIFIC LEGAL RIGHTS AND YOU MAY ALSO HAVE OTHER RIGHTS WHICH VARY FROM STATE TO STATE.