



Selectable Round High Bay

PROJECT INFORMATION

JOB NAME	
FIXTURE TYPE	Selectable Round High Bay
CATALOG NUMBER	
APPROVED BY	

SPECIFICATIONS

Construction:

The heavy duty construction is made of die cast aluminum with a polycarbonate lens. The unit has built-in heat sink and comes with a hook made of die-cast aluminum for a strong and easy installation. A unique feature is the quick disconnected cable, it can quickly separate the driver from the LED module for easy maintenance. Lens is rated IK06 and housing is rated IK08 per IEC 66262 mechanical impact code

Electrical:

AC Input: 120/208/240/277V

6' Power cord included

Constant current, Class 2 120-277 VAC, 47-63Hz

High Efficiency – min. 85%

Off-State Power: 0 Watts

Dimming 0-10V

Temperatures: Min Start: -20°C Max: 50°C

L70 Calculated Life: >50,000 Hours¹

LEDs:

Atlas LEDs provide higher lumen output, greater energy efficiency and more reliable fixture performance. IRHS series fixtures operate at 4000K, 4500K or 5000K CCT.

Ratings:

IP65

Listings:

Luminaire is certified to UL/cUL Standards for Damp Locations
DesignLights Consortium qualified luminaire, eligible for rebates from DLC member utilities.

Testing:

Atlas LED luminaires have been tested by an independent laboratory in accordance with IESNA LM-79 & LM-80.

Warranty:

Five-year limited warranty



DIMENSIONS

Weight: 10.1 lbs.

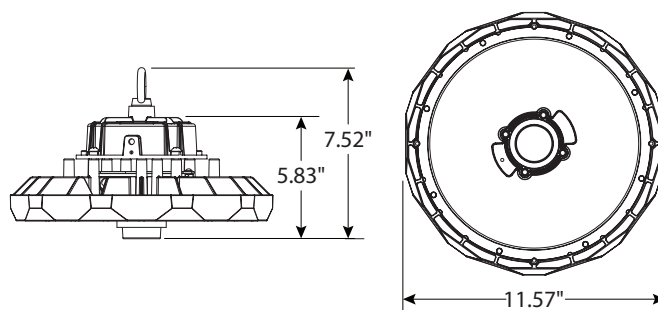

¹LED Life Span Based Upon LM-80 Test Results

ORDERING INFORMATION

IRH	S	18-30L				
PRODUCT SERIES	SELECTABLE	LUMEN PACKAGE	VOLTAGE	COLOR TEMP.	HOUSING COLOR	OPTIONS
IRH = LED Industrial Round High Bay	S = Selectable	18-30L = 18,000 - 30,000 Selectable Lumen	Blank = 120-277V 4 = 480V	blank = Selectable (4000K, 4500K, 5000K)	Blank = Black	EB = Emergency Back-Up P1 = 15A 125V Locking Plug L5-15P P2 = 15A 250V Locking Plug L6-15P P3 = 15A 277V Locking Plug L7-15P P4 = 20A 277V Locking Plug L7-20P

PERFORMANCE DATA

LUMEN PACKAGE	CRI	SELECTABLE 4000K CCT			SELECTABLE 4500K CCT			SELECTABLE 5000K CCT			REPLACES Up To
		DELIVERED LUMENS	EFFICACY (LPW)	WATTAGE	DELIVERED LUMENS	EFFICACY (LPW)	WATTAGE	DELIVERED LUMENS	EFFICACY (LPW)	WATTAGE	
18-30L	80	18090	134	135	20790	154	135	18765	139	135	175W MH
	80	24120	134	180	27720	154	180	25020	139	180	250W MH
	80	30742	123	251	34253	144	238	31535	125	252	400W MH

DLC PRODUCT INFORMATION

UNIT	5000K CCT	
	DLC PRODUCT ID	CLASSIFICATION
IRHS18-30L	S-W6GVY8	Standard

ACCESSORIES

OPTICAL ACCESSORIES



RHB16SAR

White Spun Aluminum Reflector



RHB16FGC*

16" Flat Glass and Clamp Band

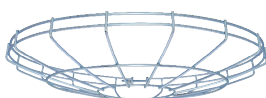

RHB16WG*

16" Wireguard



RHB16PAR

Prismatic Acrylic Refractor



RHB16CLC*

16" Conical Lens & Clamp Band

**Requires Reflector or Refractor*

PENDANT MOUNT



ORRH-PMK

Pendant Mount Adaptor Kit
Fits 3/4" NPT

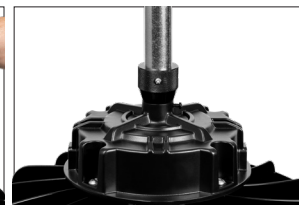

MOTION



IRH-MOT

Center Mount Motion

QCALBMSD35

AirLink Blue quick control
Bluetooth sensor